

Installing the WMFP Series Wall Mount

TOOLS REQUIRED

Flat screwdriver

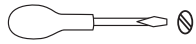

Electric screwdriver/drill

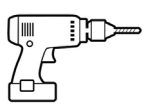

Wrench (10/12)



Level

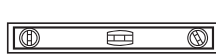

1.

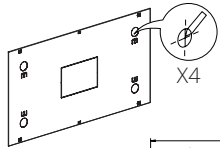

DIMENSIONS		
Model	"A"	"B"
6U	12.5	7.5
9U	17.75	12.75

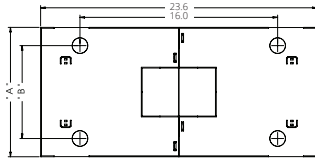

3.

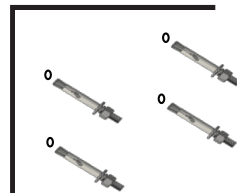

2.

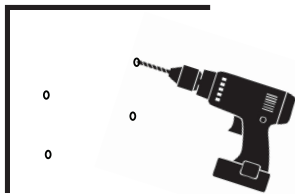

4.

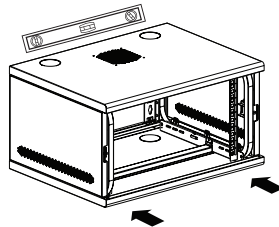

5.

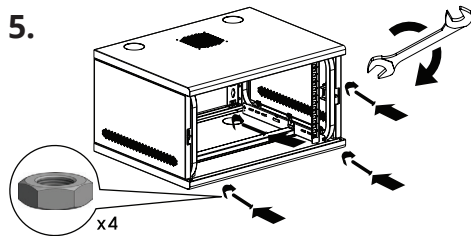

1. IT equipment must be installed on 19" mounting rails.
2. IT equipment should be installed on bracket or shelf that mounts with front and rear 19" mounting rails.
3. Do not place any item exceeding 9 lbs (4 kg) directly on bottom panel.

When installing a Great Lakes wall mount to materials such as wood, cinder block, concrete, etc., please consider the load capacity within the wall mount structure, and be certain to check with local authorities to determine the appropriate hardware requirements for these conditions. Because wall compositions may vary at different installation sites, Great Lakes cannot warrant the fitness or suitability of any installation instructions or installation hardware it may provide for wall mount. Great Lakes hereby DISCLAIMS ALL WARRANTIES, EXPRESS AND IMPLIED, INCLUDING THE IMPLIED WARRANTIES OF MERCHANTABILITY AND FITNESS FOR A PARTICULAR PURPOSE, REGARDING THE SUFFICIENCY, FITNESS OR SUITABILITY OF ANY INSTALLATION INSTRUCTIONS OR INSTALLATION HARDWARE GREAT LAKES MAY PROVIDE FOR WALL MOUNTS. Great Lakes recommends that an experienced maintenance and/or technical person be consulted regarding the proper wall mount hardware and procedures to be used for the anticipated load capacity of the wall mount.

Product specifications are subject to change without prior notice.



WMFP Series Assembly & Installation Instructions



GreatCabinets.com

1.866.879.4522



ETSI Associate Member

MS-5.02-76, REV #2

Great Lakes Flat Pack wall mount is a single section unit suitable for most IT applications. The patented design eliminates assembly hardware while the unique heavy duty steel tube frame supports 132 lbs. (60 KG) We have enhanced security and improved access with swing out side panels which can only be opened from the inside. The high density perforated front door is equipped with a sturdy lock to prevent unauthorized access.

ASSEMBLY (make sure you have all parts shown before assembly)

PARTS LIST

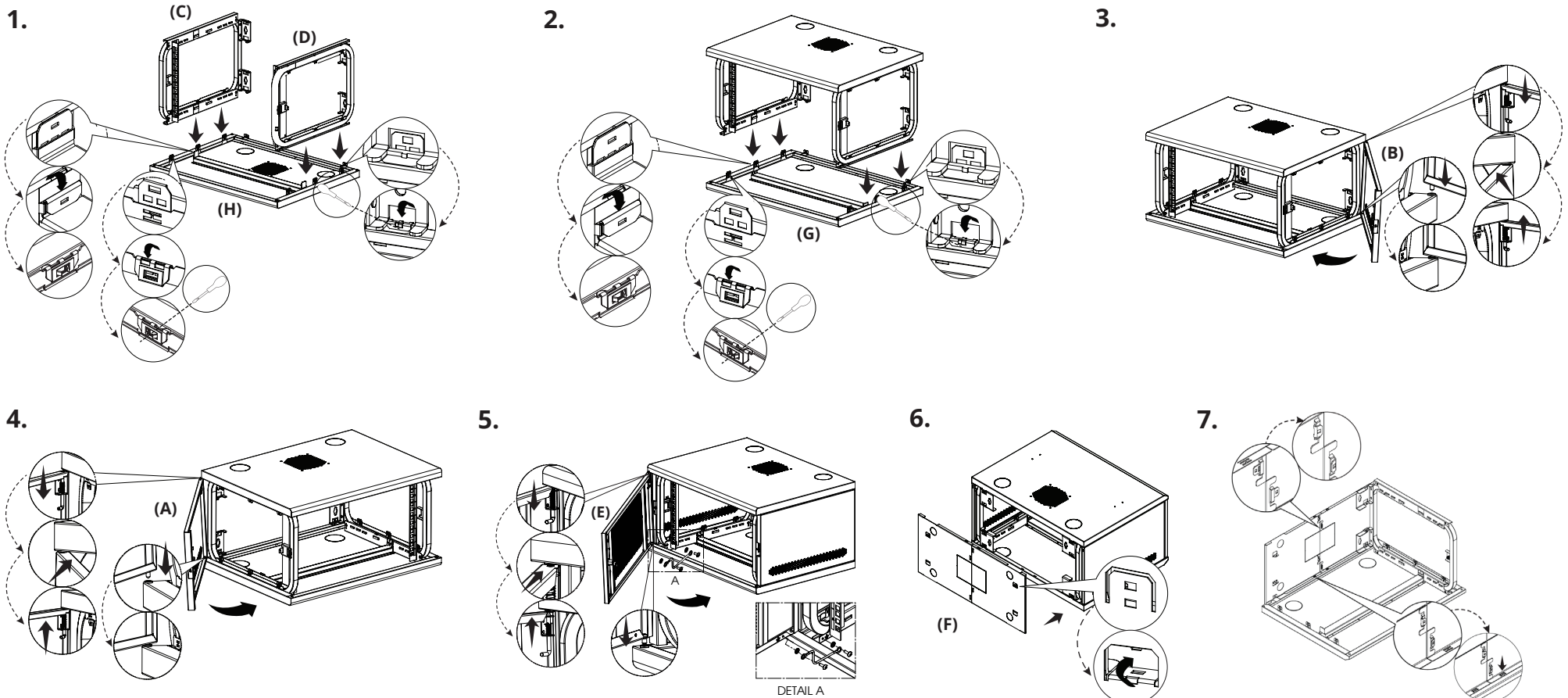
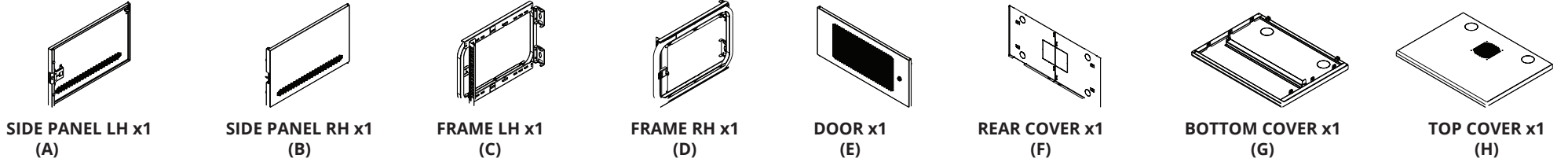

Inside view for assembly of back cover
Fasten it down with a screwdriver



WARNING: Product can be damaged when handled incorrectly. We recommend lifting the product at the edges.