

VCMP

6, 10, 12"W SIZES COMMONLY FOUND ON SPEC PROJECTS

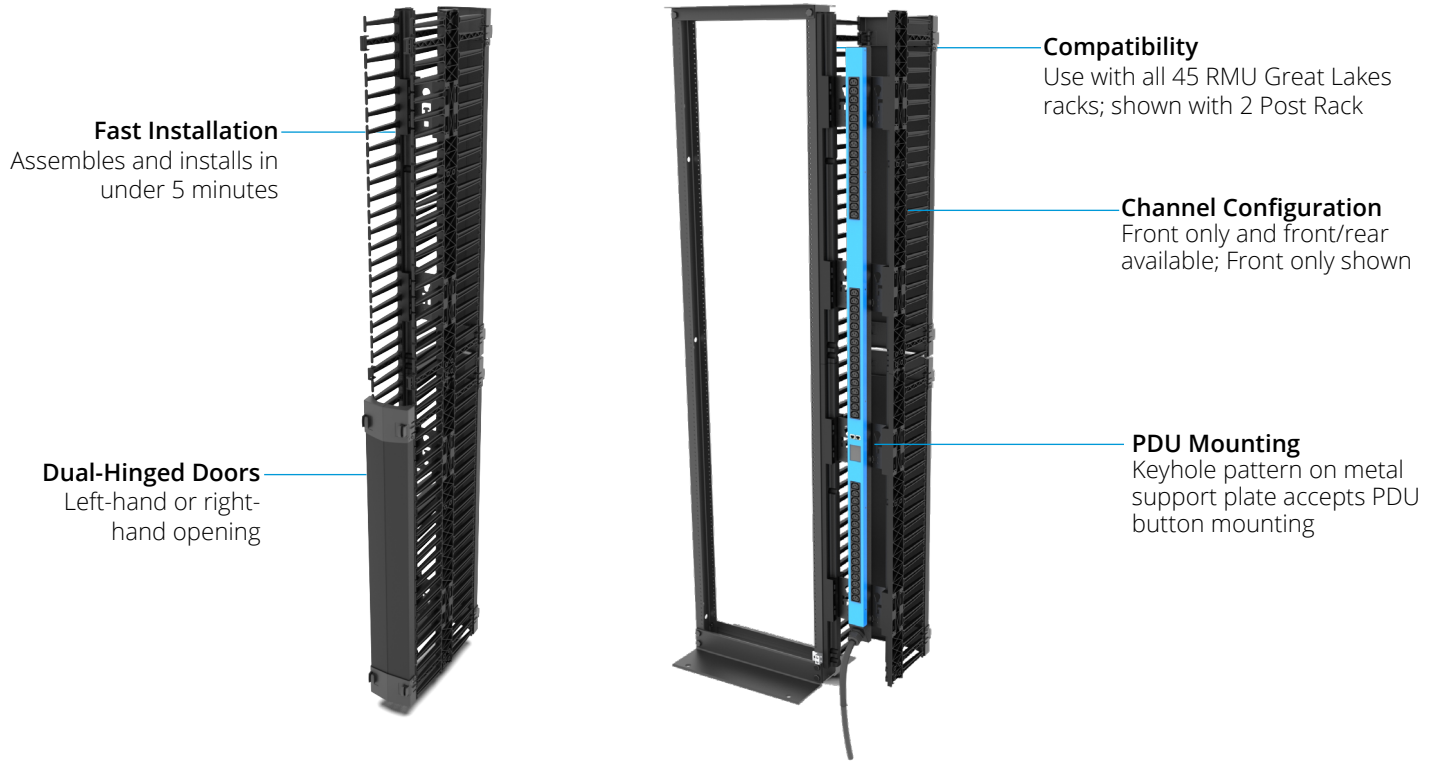

Height	Width	Channel Config.	Example
VCMP-45U-	xx06	xx	Configured VCMP
	06 (6")	FO (Front only)	VCMP-45U-0606FR
	10 (10")	FR (Front & rear)	
	12 (12")		

FEATURES

- Front only and front/rear configurations compatible with all 45RU Great Lakes racks
- 6, 10, and 12" width; 6" finger depths
- Tool-less, snap-together design for assembly in under five minutes
- Metal Support Plates serve as the VCM backbone
- Support plates feature keyhole pattern for PDU mounting (optional PDU pictured) are repositionable to divert cable toward the front or rear
- Dual-hinged doors for easier equipment installation
- Ships flat packed for improved storage, shipping and handling
- Color: Black

VCMP-FO

VCMP-45U-1006FO shown; visit GreatCabinets.com for specifications of other part numbers

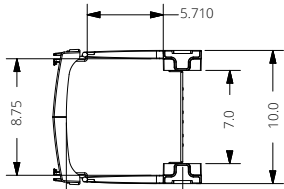

TOP VIEW

Reversible Cover Latch/Hinge

Split Height Covers

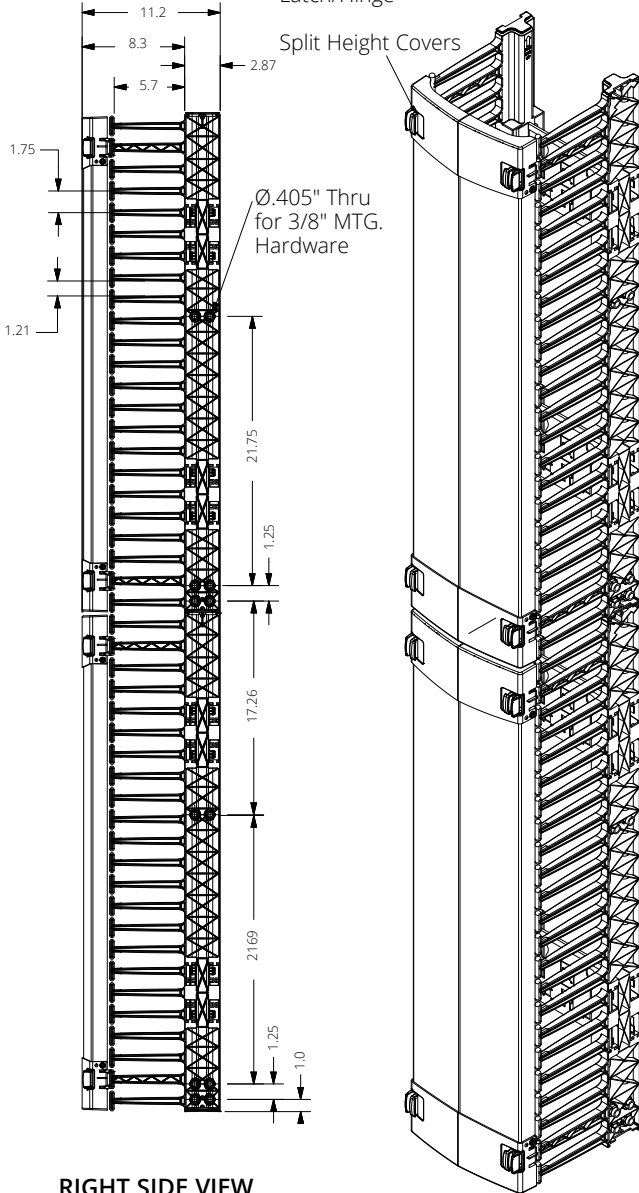

RIGHT SIDE VIEW

VCMP-FR

VCMP-45U-1006FR shown; visit GreatCabinets.com for specifications of other part numbers

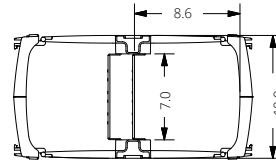

TOP VIEW

Reversible Cover Latch/Hinge

Split Height Covers

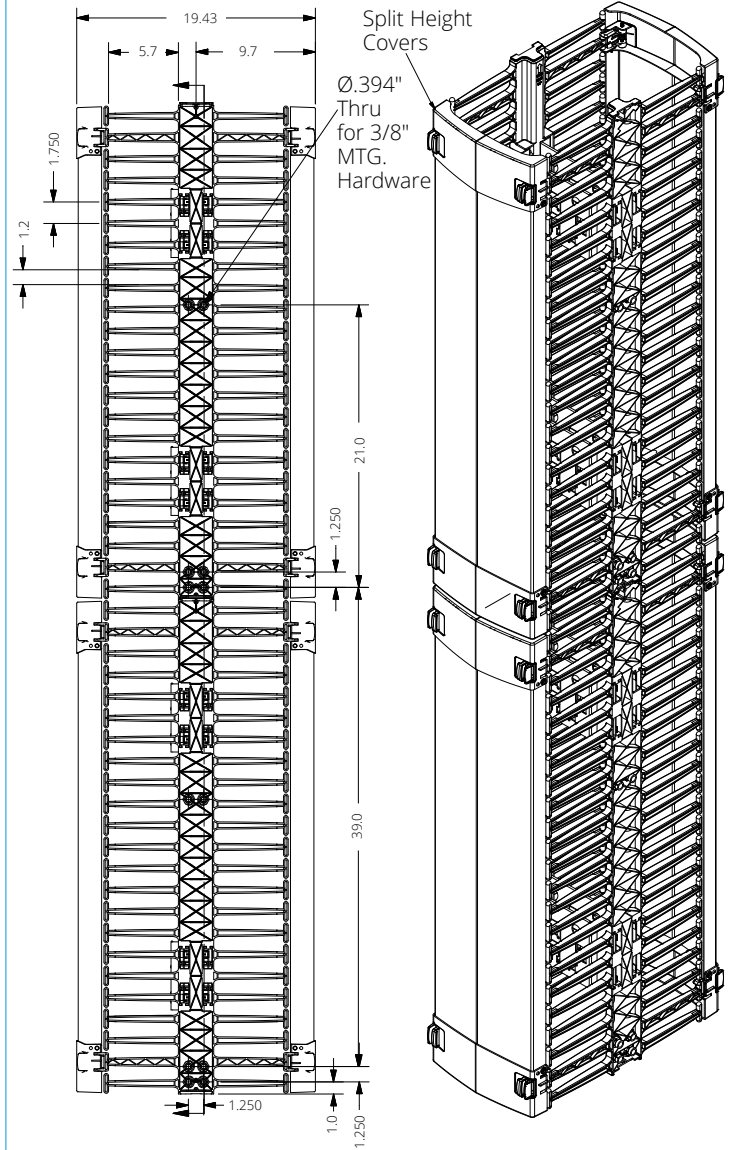

RIGHT SIDE VIEW

	Total Area (sq. in.)	Effective Area (sq. in.)	CABLE DIAMETER IN. (MM)												
			0.13 (3.30)	0.15 (3.81)	0.17 (4.32)	0.19 (4.83)	0.21 (5.33)	0.23 (5.84)	0.25 (6.35)	0.27 (6.86)	0.29 (7.37)	0.31 (7.87)	0.33 (8.38)	0.35 (8.89)	
VCMP-45U-0606FO ¹	42.75	17.10	1011	760	591	473	387	323	273	234	203	177	157	139	
VCMP-45U-0606FR ²	71.25	28.50	1686	1266	986	789	646	538	456	390	338	296	261	232	
VCMP-45U-1006FO ¹	78.75	31.50	1863	1400	1089	872	714	595	504	432	374	327	289	257	
VCMP-45U-1006FR ²	131.25	52.50	3106	2333	1816	1454	1190	992	840	720	624	546	482	428	
VCMP-45U-1206FO ¹	96.75	38.70	2289	1720	1339	1072	877	731	619	530	460	402	355	315	
VCMP-45U-1206FR ²	161.25	64.50	3816	2866	2231	1786	1462	1219	1032	884	766	671	592	526	

Note: Manager cable capacities reflect a calculated fill-rate of 40% which is intended to reflect 100% fill during actual use to de-ratings associated with cable entry/exit; If using for slack storage above capacities should be further reduced by 50% to accommodate individual cables being routed twice within managers.

¹ Cable capacity based upon internal dividers installed in deepest position

² Double sided manager capacities are for the entire manager - the capacity for each side can be calculated at 40%, 50% or 60% of this value dependent upon internal divider positioning.